

Hopper Extension Kit
for Speed Feed System

Inst. No. 10-01-1009

Edition 05-2014

For Model Numbers:**10-01-1002, for 1-Line, 60# Chain Feeder****10-02-1005, for 2-Line, 60# Chain Feeder**

The Hopper Extension Kits are designed to adapt to the Breeder Feeder, Speed Feeding System. The Hopper Extension will hold approximately 250 pounds of feed.

Determine if you have a 1-Line or a 2-Line Feed Hopper and follow the steps below.

Hopper Extension Kit Installation:**1-Line Feeder Installation:**

Step 1. Mount the Hopper Support Angles to the Chain Feeder Hopper as shown, with the ends of the Support Angles under the top lip of the Hopper. Square Clamp Washers are not required on the 1-Line Feeder. Note: Each Eye Bolt has an inverted kep nut mounted before installation.

DO NOT TIGHTEN THE ASSEMBLY UNTIL ALL COMPONENTS ARE MOUNTED IN PLACE!

This will allow adjustment for correct fits without forcing the parts.

Step 2. Assemble the Extension Kit as shown on the following pages. The assembly of the basic hopper will require, two Flat Side Panels, two Flanged Side Panels, #10-24 Slot Headed Machine Screws and #10-24 Kep Nuts. Add the two Tinnerman Nut Retainers for the Thumb Screws to the bottom of the extension at the square holes on each side panel (see drawing). Install the Hopper Extension Assembly to the Chain Feeder, between the two Support Angles as shown. Use the Thumb screw and Tinnerman Nut Retainers to anchor the Angles to the extension.

Step 3. Assemble the Extension top as shown. Use the remainder of the nuts and bolts for this assembly. The top will set onto the basic extension body. The drop tube from the fill system, will enter through the top opening.

2-Line Feeder Installation:

NOTE: Assembly of the Two Line Feeder Extension as shown. Assemble the Support Angles, Clamp Washers, Eye Bolts, and Nuts as shown. Note: the two Square Clamp Washers (P/N 6) are mounted opposite the angled corners as shown. Otherwise, the assembly of the extension is the same as the 1-line Feeder.



WARNING: BE CAREFUL WHEN HANDLING SHEET METAL PARTS AS THE SHEARED EDGES MAY BE SHARP. A STURDY PAIR OF GLOVES IS RECOMMENDED.

The parts list for the **1-Line (A)** and **2-Line (B)** Hopper Extension Kits are shown below.

(A)	10-01-1002 Hopper Extension Kit, 1-Line Chain Feeder			
(B)	10-02-1005 Hopper Extension Kit, 2-Line Chain Feeder			
NOTE: For parts (A) and (B) Refer to the parts list below.				
Item	(A) Quantities	(B) Quantities	Part No	Description
1	2	0	10-01-1003	Support Angle, Hopper-1 Line, 16-3/4 in.
2	0	2	10-02-1003	Support Angle, Hopper-2 Line, 19 in.
3	4	4	10-01-1004	Roof Panel
4	2	2	10-01-1005	Side Panel, Flat
5	2	2	10-01-1006	Side Panel, Flanged
6	0	2	10-01-1008	Clamp Washer, Square
7	4	4	99-50-0094	Eye Bolt, .38-16 x 2.5 in., .88 ID Eye
8	8	8	99-20-0097	Kep Nut, .38-16
9	2	2	99-20-0224	Retainer Nut, "Tinnerman", .25-20
10	2	2	99-10-0110	Thumb Screw, .25-20 x 1/2 in.
11	36	36	99-10-0118	Machine Screw, Slot Truss Hd. 10-24 x .38
12	36	36	99-20-0089	Kep Nut, 10-24
13	0	2	10-02-1004	Support Filler-2 Line, 23 1/4 in.

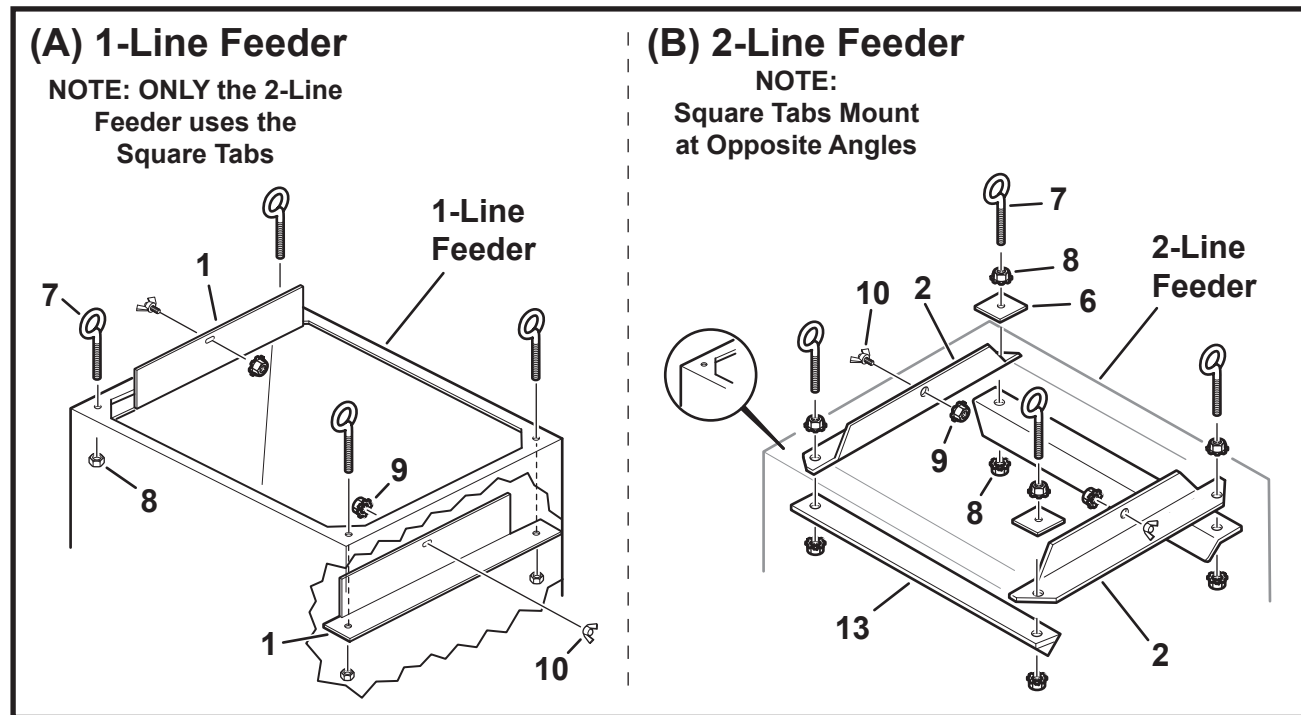

10-00-0763-08

The drawing above shows the Hopper Support Angles for the 1-Line and 2-Line Hopper Body.

Hopper Extension Kit

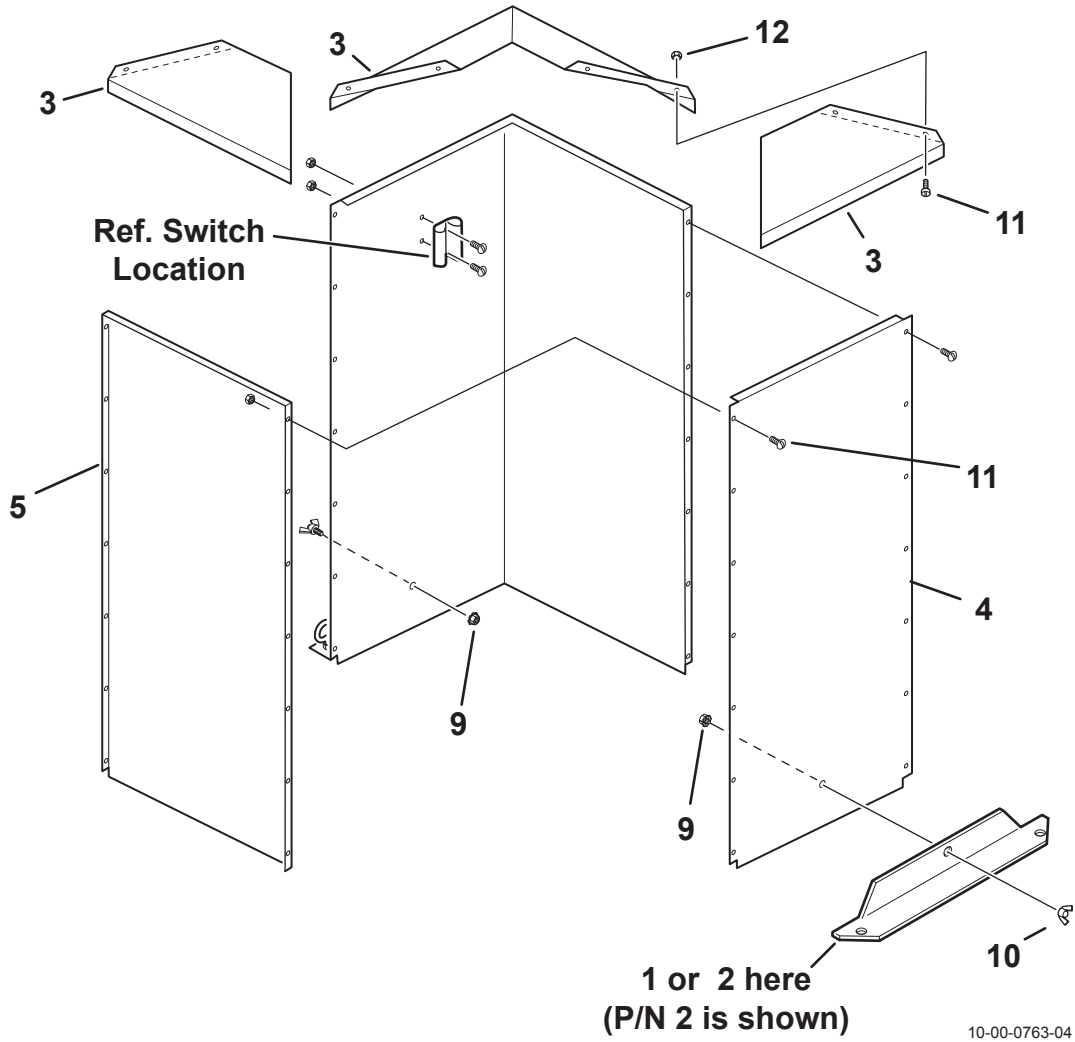

Big Dutchman, Inc. Limited Warranty

Big Dutchman, Inc. (“**Big Dutchman**”) warrants to original purchaser (“**Buyer**”) that goods manufactured solely by Big Dutchman (“**Products**”) will be free from defects in material or workmanship under normal and intended use and service for a period of one year from delivery date of the Products except that the Products shall not be defective to the extent that (i) they conform with drawings of or specifications for or a sample of goods that have been approved by Buyer; (ii) they conform with goods, testing results, dimensional layouts or manufacturing methods that have been submitted and approved by Buyer; (iii) they are damaged due to the method or length of storage by Buyer; or (iv) to the extent they conform to the specifications as changed or waived if Buyer’s representative agrees, either orally or in writing, to the change in or waiver of the specifications for any Product.

In the event of a defect in any Products constituting a breach of the warranty provided herein, Big Dutchman will at its option either (i) repair or replace such Product free of charge, or (ii) in lieu of repair or replacement, refund to Buyer the original purchase price less the reasonable value of Buyer’s use of the Products. Big Dutchman shall furnish to Buyer instructions for the disposition of the defective goods. Big Dutchman shall have the option of requiring the return of the defective goods, transportation prepaid, and proof that the goods were not used, installed or altered or subject to misuse or abuse to establish the claim. No goods shall be returned to Big Dutchman without its prior consent. The acceptance of any goods returned to Big Dutchman shall not be deemed an admission that the goods are defective or in breach of any warranty, and if Big Dutchman determines that the goods are not defective they may be returned to Buyer at Buyer’s expense. This warranty sets forth Buyer’s sole and exclusive remedies for any defect in the goods. The rights and obligation under this warranty may not be assigned or delegated to a third party by Buyer without the prior written permission of Big Dutchman. Neither Buyer nor any other person may modify or expand the warranty provided herein, waive any of the limitations, or make any different or additional warranties with respect to the Products. Any statements to the contrary are hereby rendered null and void unless expressly agreed to in writing by an authorized officer of Big Dutchman.

EXCEPT AS STATED IN ABOVE, BIG DUTCHMAN DOES NOT MAKE ANY WARRANTY AS TO THE GOODS OR SERVICES AND, IN PARTICULAR, DOES NOT MAKE ANY WARRANTY OF MERCHANTABILITY OR FITNESS FOR ANY PARTICULAR PURPOSE, AND BUYER IS SOLELY RESPONSIBLE FOR DETERMINING THE PROPER APPLICATION AND USE OF THE GOODS.

Big Dutchman makes no representation or warranty that individual animals, or any given population of animals, will utilize any of Big Dutchman’s goods in the manner for which the goods were intended or designated. Any component parts that are not manufactured by Big Dutchman, such as electrical motors and controls, are excluded from any warrant by Big Dutchman, although such parts may be covered by separate warranties of the respective manufacturers. This warranty set forth above does not apply if all components of a system are not supplied by Big Dutchman or if the goods are not purchased from and installed by an authorized distributor or company warehouse, or installed and operated in accordance with Big Dutchman’s specifications and instructions.

BIG DUTCHMAN SHALL NOT HAVE ANY TORT LIABILITY TO BUYER OR ANY OTHER PERSON WITH RESPECT TO ANY OF THE GOODS OR SERVICES AND SHALL NOT BE LIABLE FOR CONSEQUENTIAL, INCIDENTAL, SPECIAL, EXEMPLARY, INDIRECT OR PUNITIVE DAMAGES ARISING FROM ANY PRODUCT DEFECT, DELAY, NONDELIVERY, RECALL OR OTHER BREACH. BUYER SHALL NOT HAVE ANY RIGHT OF REJECTION OR OF REVOCATION OF ACCEPTANCE OF THE GOODS.



Big Dutchman

Germany
P.O. Box 11 63 · D-49360 Vechta · Germany
tel +49 (0) 44 47 801 0 · fax +49 (0) 44 47 801 237
www.bigdutchman.com · big@bigdutchman.de

Asia-Pacific
No. 25 Jalan Pemberita (U1/49), Temasya Industrial Park
40150 Shah Alam · Selangor Darul Ehsan · Malaysia
tel +603 5569 2320 · fax +603 5569 5930
bdasia@bda.com.my

USA
P.O. Box 1017 · Holland, MI 49422-1017 · USA
tel +1 616 392 5981 · fax +1 616 392 6188
www.bigdutchman.com · bigd@bigdutchmanusa.com

Brazil
Caixa Postal 84 · Rua Victorio Milani, 125
Caxias do Sul, RS 95095-107 · Brasil
tel +55 (0) 54 226 2200 · fax +55 (0) 54 226 1424
www.bigdutchman.com.br · bigdutchmanbrasil@bigdutchman.com.br